

WORKMASTER®

WE FIND A WAY — OR MAKE ONE !



GO-A13-HA



GO-A3-PW



GO-A8-PW



GO-M3



GO-E2



GO-M04



GO-A2

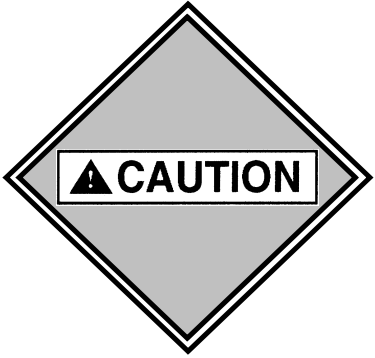

MAKE SAFETY PRIORITY ONE!

Owning and maintaining the proper tools and accessories is the first step in creating a safe working environment. All the items in this catalog are designed to not only help open and unload stubborn Railcar Gates but to do so in the safest possible way.

WHY IS SAFETY IMPORTANT?

- ◆ Each year 1 in 8 workers is injured on the job.
- ◆ On average 17 people are killed each day in the Industrial and Construction workplace (Safety is not just about preventing injury - it's a matter of life and death).
- ◆ Most accidents are caused by carelessness, taking short-cuts or simple neglect.

While we pride ourselves in the quality and dependability we build into **WORKMASTER** products, we caution tool users that it is only prudent to know and follow the simple rules of Safety when using our products, or anyone else's.

FOLLOW THESE SAFETY TIPS:

- ◆ Always wear eye protection when near an operating Gate Opener.
- ◆ Only use Drive Fittings, Extensions and Universal Joints that are in good condition. Worn Sockets reduce impact power and could shatter, resulting in personal injury.
- ◆ When using a Drive Fitting Extension and/or Universal Joint, never operate the Gate Opener when not engaged in the Railcar's Capstan.
- ◆ Never continue to operate the Gate Opener after the gate is completely open or completely closed.
- ◆ Always use the simplest hook-up possible. If your Drive Fitting Extension and/or Universal Joint is not needed, remove tool(s) to reduce wear.
- ◆ Never hold Drive Fitting, Universal Joint or extension when Gate Opener is running.
- ◆ Before every use, visually inspect accessories for damage and cracking; immediately replace all damaged attachments.
- ◆ Always wear gloves when hammering Swage Tool into Capstan.
- ◆ Disconnect Gate Opener's air supply when changing attachments.
- ◆ Never use nuts and bolts to secure attachments to Gate Opener protruding ends are dangerous and against OSHA regulations.

DRIVE FITTING



If you're serious about opening and unloading railcars, your Gate Opener – regardless of make or model – needs a serious Drive Fitting. **WORKMASTER's** tapered, 1-piece Drive Fitting is designed to fit every railcar capstan with full contact on all sides. Its 1-1/2" Female Sq. socket allows this Drive Fitting to be used with a variety of Gate Openers. With a forged core and precision machined sides – tapered from a 1-1/2" square to a 3/4" square tip **WORKMASTER's** 1-piece Drive Fitting – will become your Gate Opener's best friend.

PART #
33-10013

DRIVE FITTING EXTENSIONS

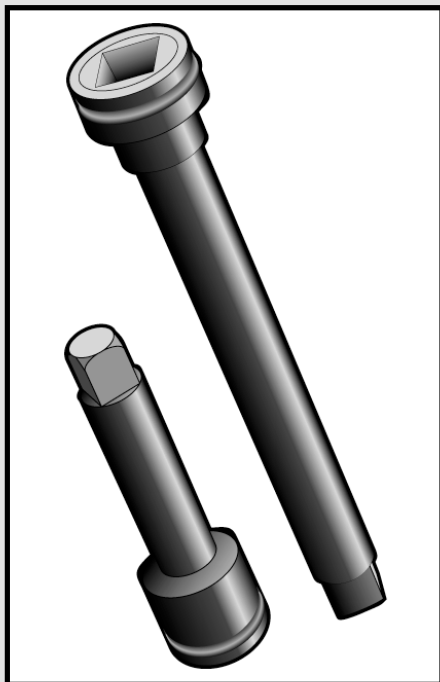

Unmoveable obstacles and/or unloading site gaps can make getting your Gate Opener close to the Railcar's capstan impossible! **WORKMASTER's** heavy-duty 12" and 20" Drive Fitting Extensions make the impossible possible. Each Extension is designed to not only extend your Gate Opener's reach, but to do so without any torque loss. Their precision machined, impact resistant, hardened steel construction makes them the ideal Gate Opener accessories.

PART #	
12"	33-10012
20"	33-10020

UNIVERSAL JOINT



Covered Hopper Cars come in a variety of shapes and sizes, and the height of a capstan and the surrounding terrain can vary just as much. **WORKMASTER's** heavy duty Universal Joint can overcome these height variances by positioning your Drive Fitting directly in-line with the center of the capstan. Correct alignment with the capstan is critical to the life of your Gate Opener and can insure the solid in-line entry of the Drive Fitting on even the steepest of railroad slopes.

PART #

33-10090

PIN & RING CONNECTOR

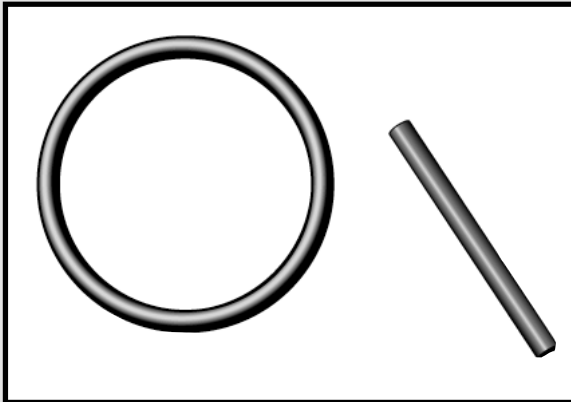

If your unloading site sees a variety of railcars and you're constantly changing the accessories on your Gate Opener, you'll need **WORKMASTER's** Pin & Ring Connectors to help keep the job moving. The Pin is hardened steel; the Ring is nick-resistant rubber, together they make changing from your 12" Extension to your Universal Joint, to your 20" Extension, quick and easy. **WORKMASTER's** Pin & Ring Connectors are also OSHA approved because there are no protruding ends that can damage property or injure workers.

PART #

PIN 32-50124

RING 32-50000

SWAGE KIT



Over time, the inside edges of a railcar's capstan can wear and become rounded. When this happens opening and unloading a hopper car becomes an inefficient and costly task. **WORKMASTER's** tapered Swagging Tool Kit can bring new life to the dulllest of capstans. With just a few hammer blows, worn or damaged capstans are quickly renewed. The Swagging Hammer can deliver 40% more driving force than conventional style hammers. It has a 15" overall length and a 2-1/2" face that makes hitting the targeted Swage Tool a cinch – every time. With an ergonomic grip design and weighing only 48oz. the Swagging Hammer is comfortable and easy to swing. Our Swage Tool and Swagging Hammer can deliver the results you need to get difficult capstan sockets squared-up and ready to rotate. Machined from Grade 4140 tool steel and specially heat treated for proper hardness, **WORKMASTER's** Swage Tool will soon become your unloading sites most popular accessory.

PART #

33-11120

RET-RING CONNECTOR

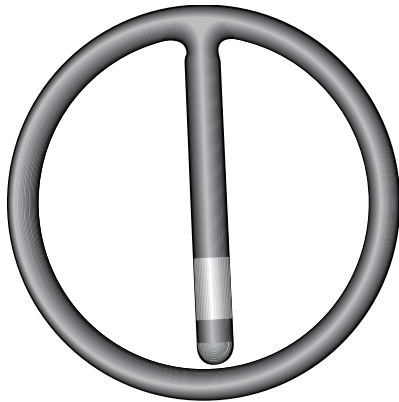

NEW!

WORKMASTER's 1-1/2" Ret-Ring Connector secures your Drive Fitting to your Gate Opener, Extension or Universal Joint. One piece, molded of durable polyurethane, with a steel insert for added safety, the Ret-Ring Connector makes changing accessories quick and easy. Its bright blue color makes it easy to spot if dropped or misplaced and its enclosed design is OSHA approved for all Gate Opener and rotating tool applications.

PART #

32-50001

PROTECTIVE COVER

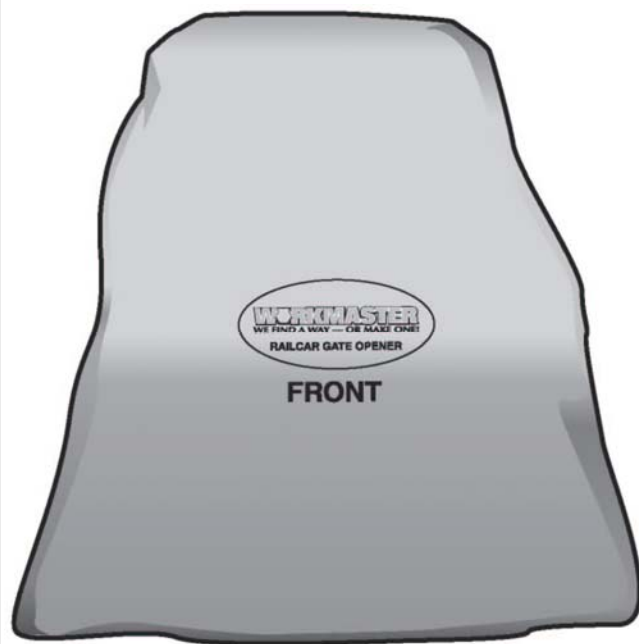

Rain, snow and plant debris can really do a number on your Hopper Car Gate Opener. But with **WORKMASTER's** water-proof, puncture resistant protective cover, you can keep your Gate Opener working and looking like new. The cover's tapered fit shelters your Gate Opener from the elements while maintaining the unit's mobility. Protect your Gate Opener from rust, dents, corrosion and dirt with **WORKMASTER's** Gate Opener cover.

PART #

30-20020

EXHAUST DIVERTER KIT

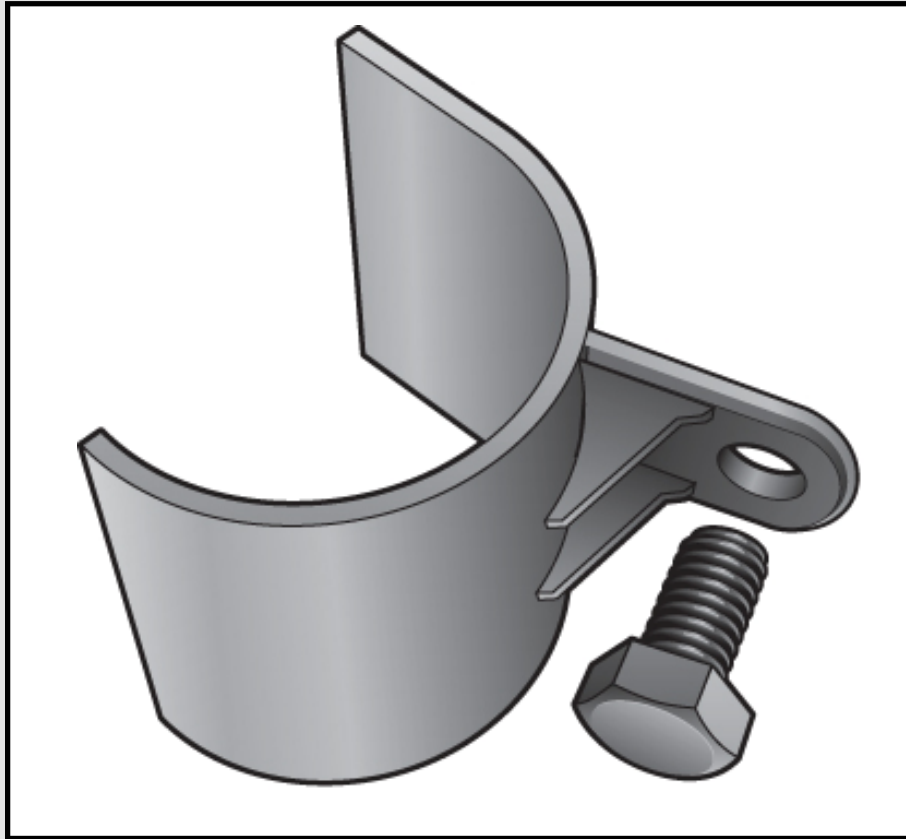

Unloading sites are, by their nature, dusty and dirty. At some sites the airborne fines and powders can cause annoying or dangerous visibility problems. The **WORKMASTER** Exhaust Diverter can't eliminate the problem, but it can improve it. By redirecting the GO-A8's exhaust to the rear, unloaded powders and fines can't surge and roll up the side of the car engulfing the operator in billows of dust and debris. This all steel Exhaust Diverter is easy to install, bolting onto the bottom of the Impactor.

PART #

33-20039

TOOL-LUBE Air Tool Oil

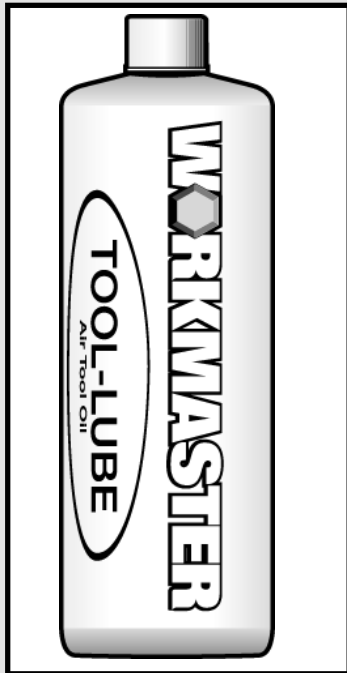

Keep your Gate Opener running longer - up to three times longer - cleaner, with less downtime and greater power using **WORKMASTER's** TOOL-LUBE Air Tool Oil. Special emulsifiers allow this unique oil to absorb 10% of its weight in water preventing the formation of rust, gum and sludge. With regular use of **WORKMASTER's** TOOL-LUBE you can expect your pneumatic Gate Opener to operate with greater performance, consistency, and reduced noise levels.

PART #	
1 Quart	36-21010
1 Case (12 Qts)	36-21014

IN-LINE LUBRICATOR

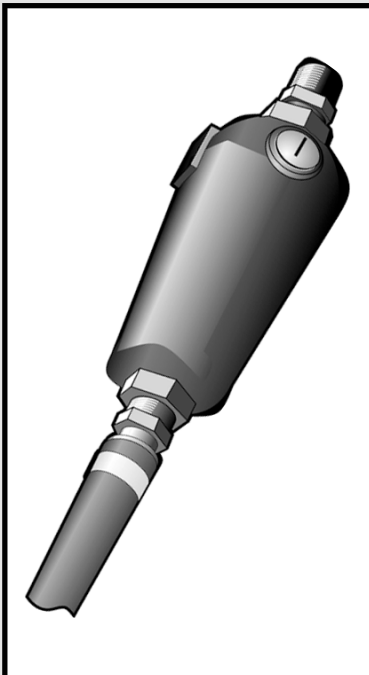

Designed for the intermittent, start/stop operation of Hooper Car Gate Openers and Vibrators, and factory set to deliver just the right amount of air tool oil, **WORKMASTER's** In-Line Lubricator is the preferred way to supply the lubrication your air powered equipment demands. Don't allow your Gate Opener or Vibrators to run dry, keep them well oiled and long running – with **WORKMASTER's** In-Line Lubricator.

- ◆ 1" NPT Threaded Ports (female)
- ◆ 16 oz. Metal Reservoir Bowl

PART #
82-40003

FRL Assembly

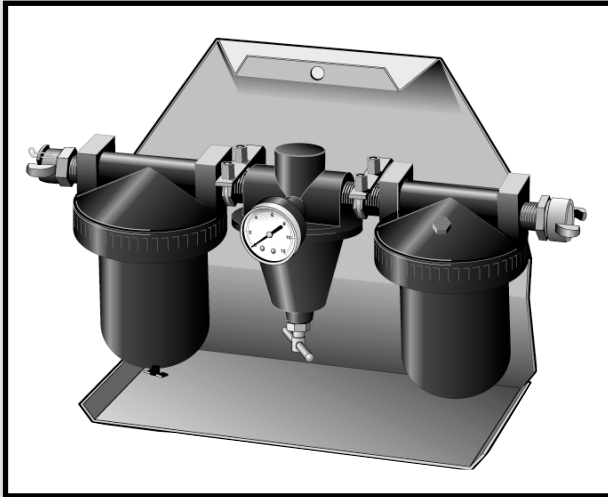

PART #
82-10330

If your Gate Opener is not designed to include an In-Line Lubricator, **WORKMASTER's** FRL Assembly is ideal. The Assembly provides the utmost in tool protection by filtering, regulating and lubricating your Gate Opener's air supply. Weighing only 23 Lbs, the FRL Assembly can be easily transported, and its continuous use can extend the life of your Gate Opener and conserve your plant's air supply.

- ◆ Universal Fittings
- ◆ 2" Diameter Gauge; 0-160 PSI
- ◆ 40 micron Filter
- ◆ 16 oz. Metal Reservoir Bowl

FILTER/DRYER Assembly

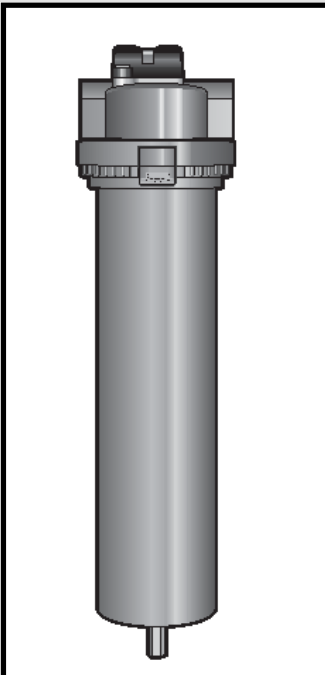

Stop water and dirt from entering your Gate Opener with **WORKMASTER's** Filter/Dryer Assembly. This unique accessory incorporates patented inverse flow technology and is engineered specifically to remove condensed liquids and dirt from the airlines feeding your Gate Opener or Pocket Vibrator. This Filter/Dryer Assembly prevents airline moisture problems from damaging your pneumatic equipment.

- ◆ 1" NPT Inlet, flows up to 150 SCFM
- ◆ Metal Bowl
- ◆ Stainless Steel Element and Cotton Cartridge

PART #
82-10420

THE POCKET ROCKET Wedge-Mount Vibrator

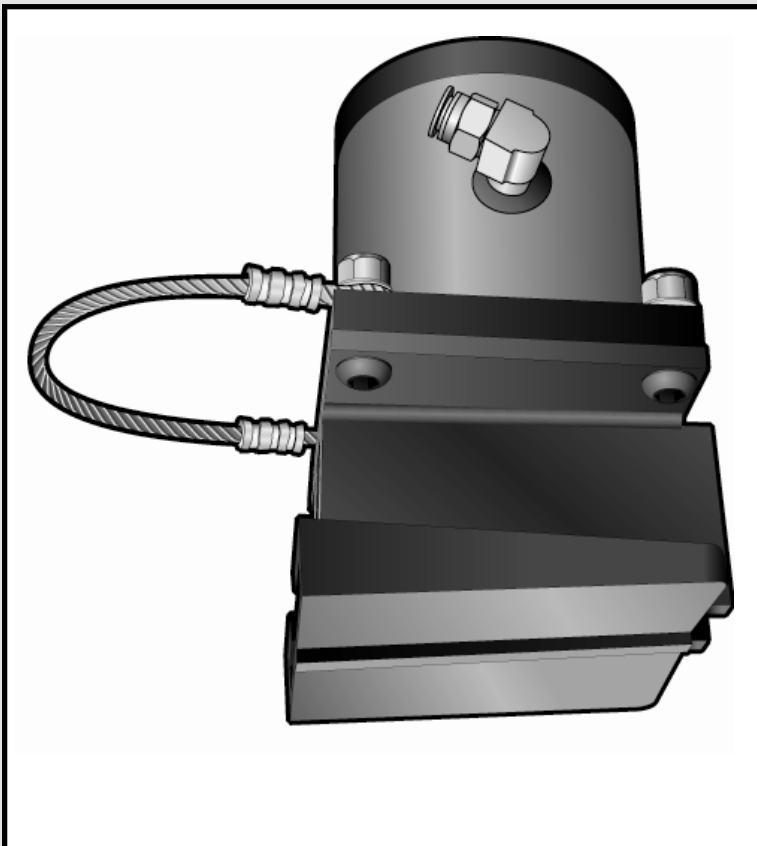

PART #

46000

Lightweight, quiet and powerful, are three words synonymous with the **POCKET-ROCKET®** wedge-mount Vibrator Assembly. With a urethane shoe wedge bracket, an easy-grip handle and weighing only 27 Lbs., the POCKET ROCKET is quiet and extremely portable. The unique urethane shoe bracket design eliminates noisy metal to metal contact with the Railcar, allowing the the vibrator to operate at less than 82 DBA. The vibrator is a compact, powerful, non-impacting linear vibrator that is highly air efficient — only 16 CFM at 90 PSI.

Each POCKET ROCKET comes equipped with:

- ◆ 6 ft Hose Whip
- ◆ Locking Ball Valve w/ Universal Coupling
- ◆ 1 Qt. Vibra-Lube Vibrator Oil
- ◆ 5 micron Filter, Regulator, Lubricator Combo

Pocket Rocket is registered trademark of Martin Engineering.

THE CAR ROCKER Wedge Mount Vibrator

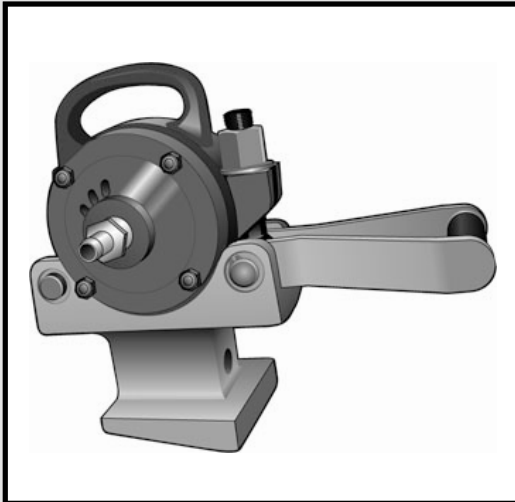

The Dual Roller CAR ROCKER Pneumatic Vibrator is ideal for applications that require high frequency and high force. **WORKMASTER's** CAR ROCKER Vibrator Assembly is one of the original heavy-duty vibrators specified for unloading railcars. With only three moving parts (vane, inner, and outer roller) the vibrator has a long wear life and requires little maintenance.

ASSEMBLY	PART #
VRH-050 w/ Bracket	16-17119
VRH-060 w/ Bracket	16-17120

PERFORMANCE DATA		FREQUENCY (VPM)			FORCE OUTPUT (LBS)			AIR CONSUMPTION (CFM)		
ASSEMBLY	UNBALANCE	40 PSI	60 PSI	80 PSI	40 PSI	60 PSI	80 PSI	40 PSI	60 PSI	80 PSI
VRH-050	1.4	9750	12500	15000	4100	6000	9750	40	54	57
VRH-060	3.4	7800	9800	11000	5500	8700	10400	32	41	49

The lug bracket is the highest quality mount available. It features heavy-duty, cast steel construction, and the seat of the wedge bracket is machined to match the curve of the vibrator body, ensuring complete contact for a secure mount.

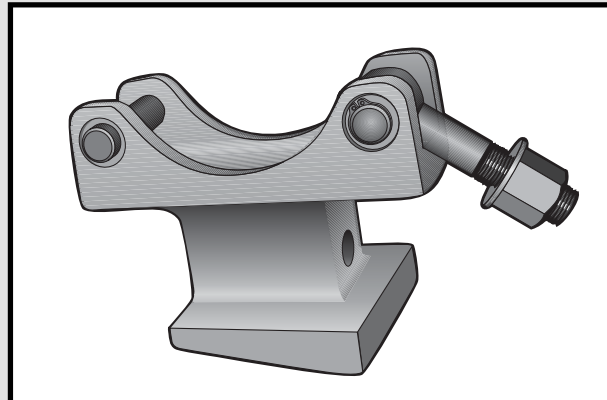

Assembly components available.

COMPONENTS	PART #
VRH-050 VIBRATOR	16-17319
VRH-060 VIBRATOR	16-17320
WEDGE BRACKET	32-17325

THE RAIL-SHAKER Wedge-Mount Vibrator

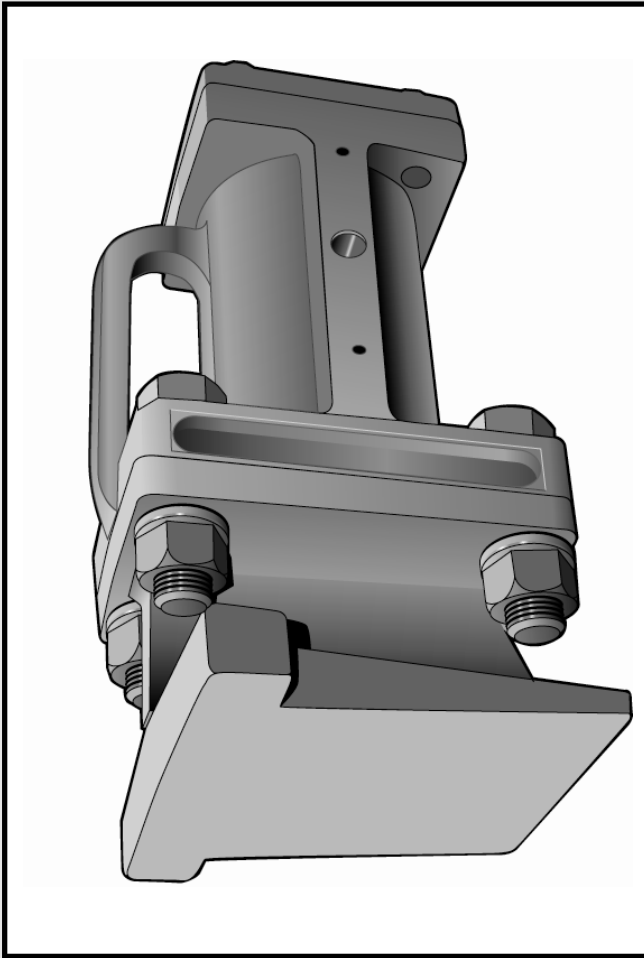

Opening a Hopper Car Gate is one thing, getting material to flow out is an entirely different problem. But not with **WORKMASTER's** air driven RAIL-SHAKER wedge-mount Vibrator. The assembly's wedge-end fits all standard hopper car side brackets and its top lugs keep the RAIL-SHAKER from jamming in the pocket. The vibrator pounds the wall of the hopper car like a fast acting sledge hammer, and its high frequency stimulates the material inside, producing instant and consistent flow.

PART #
13-15210

FREQUENCY (VPM)			FORCE OUTPUT (LBS)			AIR CONSUMPTION (CFM)		
40 PSI	60 PSI	80 PSI	40 PSI	60 PSI	80 PSI	40 PSI	60 PSI	80 PSI
1850	2000	2200	590	845	1025	9.1	17.0	21.0

Assembly components also available.

COMPONENT	PART #
PISTON VIBRATOR	13-15130
STEEL BRACKET	32-13050
FASTENER KIT	32-15400

VIBRATOR MOUNT BRACKET

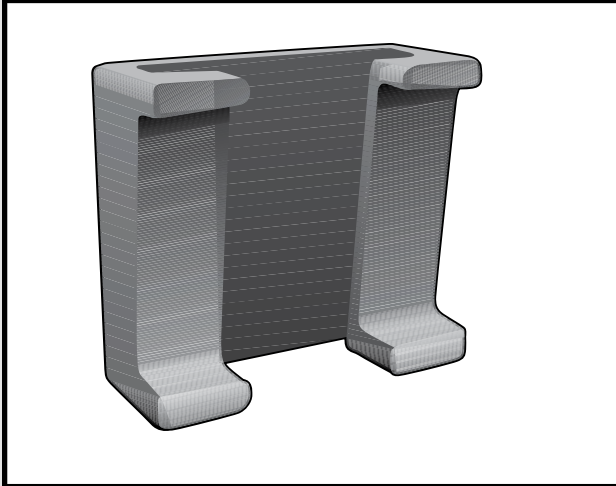

Missing or damaged railcar wedge brackets combined with stubborn, slow moving material, make unloading the Railcar nearly impossible. **WORKMASTER's** weld-on Vibrator Mount Bracket provides an easily installed mounting pocket that transmits maximum vibration from the vibrator to the railcar. Always keep a pair of these cast iron brackets around your unloading site and you'll never be slowed by missing or damaged brackets again!

PART #
32-17327

VIBRA-LUBE Vibrator Oil

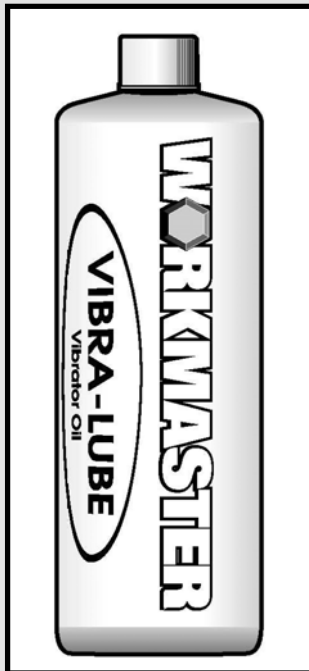

The internal parts of Pneumatic Rotary and Piston type Vibrators are subject to severe stress. These parts require a special type of lubrication. **WORKMASTER's** VIBRA-LUBE Vibrator Oil is uniquely formulated to coat and protect a vibrator's inner lining and moving parts. With regular use VIBRA-LUBE can add years of service to the life of your vibrator as well as reduce noise levels, increase air efficiency and power. For a pneumatic vibrator there is no substitute.

PART #	
1 Quart	36-21020
1 Case (12 Qts)	36-21024

AIR HOSE ASSEMBLIES

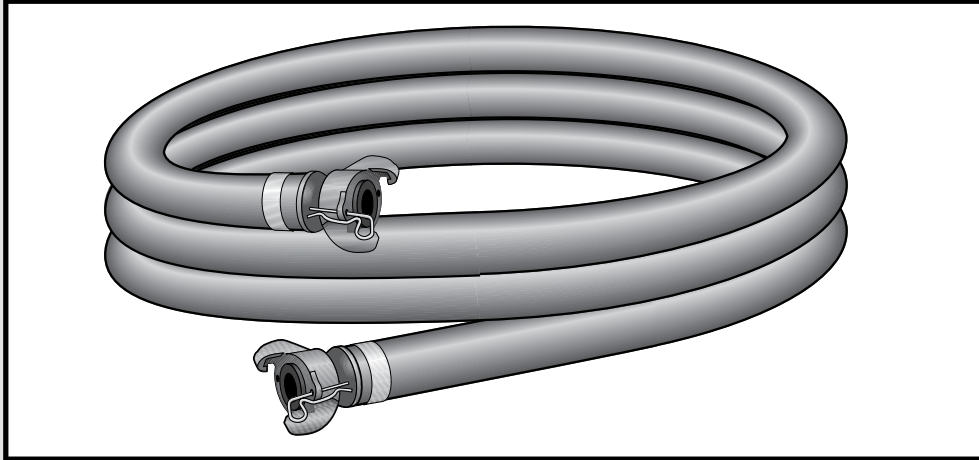

Railcar Gate Openers and Pocket Vibrators are designed to create an efficient and safe work environment. **WORKMASTER's** 1" heavy duty Air Hose Assemblies come in a range of lengths to keep your Gate Opener and Vibrators operating safely and efficiently at any distance. Each assembly is made from 200 PSI, nick-resistant, red rubber hose complete with universal fittings at each end. Don't allow worn or collapsed, cut or damaged, ready-to-burst air hose turn your unloading station into an accident waiting to happen. Replace worn and/or damaged hose lengths with **WORKMASTER's** heavy duty Air Hose Assemblies.

BEST FOR	DIAMETER	LENGTH	PART #
Gate Openers	1 "	10 ft	83-09078-09
		15 ft	83-09118-09
		25 ft	83-09134-09
		50 ft	83-09174-09
Dual Roller Vibrators	3/4 "	10 ft	83-09077-09
		15 ft	83-09117-09
		25 ft	83-09133-09
		50 ft	83-09173-09
The Pocket Rocket	3/8 "	10 ft	83-09075-09
		15 ft	83-09115-09
		25 ft	83-09131-09
		50 ft	83-09171-09

BALL VALVES

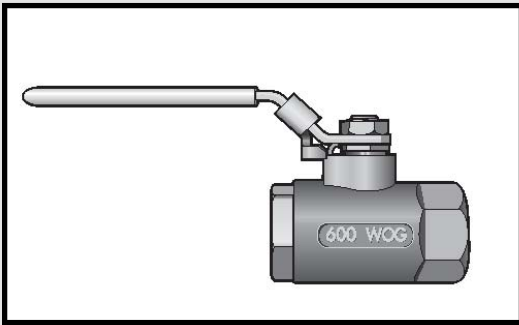

SIZE	PART#
3/8"	81-10002
1/2"	81-10003
3/4"	81-10004
1"	81-10005

Ball Valves are an integral part of an unloading site's Air System, unfortunately they're often overlooked. When strategically placed, **WORKMASTER's** Brass Lockable Ball Valves can give you greater, more convenient control over your Gate Opener and Vibrator's air supply. In addition to giving you instant shut-off capability, the correct Ball Valve can give your Vibrator the instant rush of air flow needed to begin vibration. When in the closed position each valve vents downstream air in accordance with new OSHA Regulations for pneumatic systems. Female x Female standard port; Rated to 600 PSI WOG.

TOOL-CLEAN Air Tool Cleaner

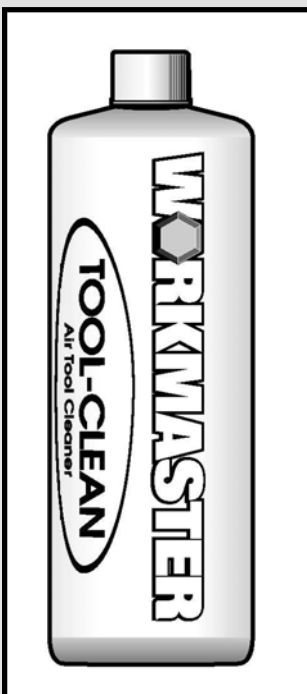

WORKMASTER's TOOL-CLEAN Air Tool Cleaner will safely remove rust, dirt and varnish from inside your Gate Opener's Impact Motor. A unique blend of additives helps prevent bearing seizure, keeps rust from affecting rotors, and improves the life of the rotor blades. Even equipment already clogged by dirt, disintegrating seals or rubber hose, or that has been inactive for a period of time can be restored to peak efficiency with a single flush of TOOL-CLEAN. Simply poured into the Gate Opener's inlet and allowed to work for 3 - 5 minutes, varnish, rust, and other accumulated debris are flushed out the exhaust with the spent cleaner.

PART #	
1 Quart	36-21040

WHIPCHECK SAFETY CABLES

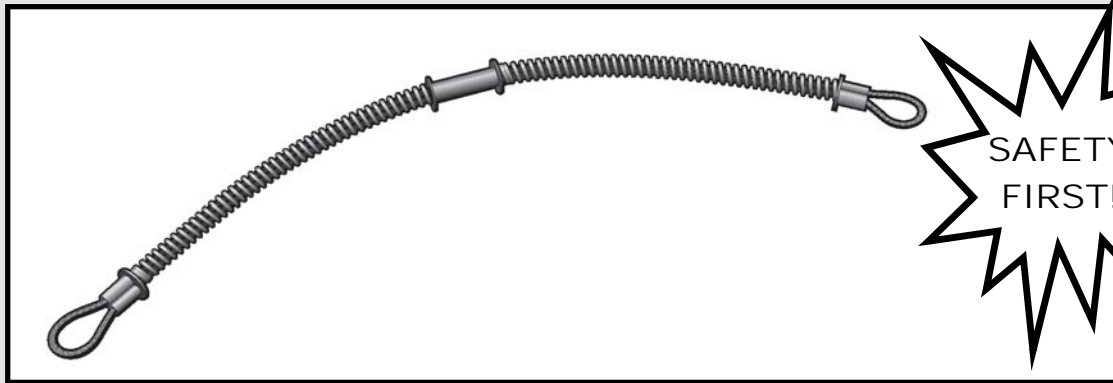

WORKMASTER's WHIPCHECK hose connection cable is a safe, positive, economical solution to the problem of injuries caused by broken air hose connections. Easily installed and removed without the use of tools, this simple device is also highly resistant to rust and corrosion. Since it is always attached to the hose, it cannot be lost, and proper installation can be easily verified even at a distance. The WHIPCHECK is an effective and inexpensive product to insure personnel safety.

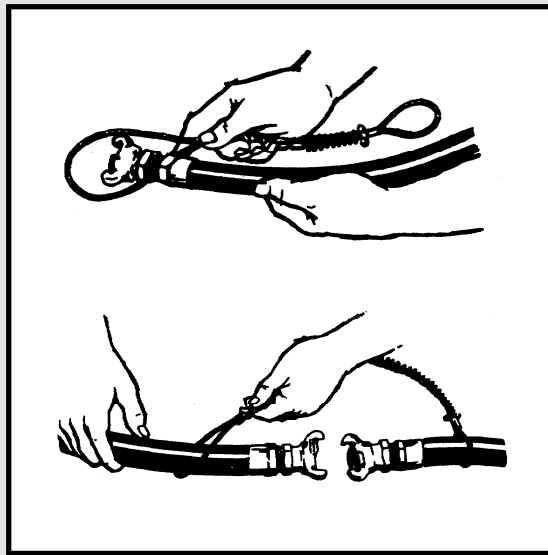

Easily installed by depressing spring and looping the wire over the hose on both sides of the connection. Release the spring and the Whipcheck locks onto the hose - a permanent, dependable safeguard.

PART #

74-10010

RECOMMENDED BY: OSHA
BUREAU OF MINES
BUREAU OF RECLAMATION
US ARMY CORPS OF ENGINEERS

AIR RECEIVER TANKS

To insure you're getting the most out of your Pneumatic Gate Opener and Railcar Pocket Vibrators your plant's air system may need some help. **WORKMASTER's** Air Receiver Tanks can deliver the additional compressed air volume your unloading site requires. All Tanks are built in accordance with the ASME Section VIII Division I Code latest edition. Each Tank is supplied with an automatic drain valve, pressure gauge and safety relief valve, making **WORKMASTER's** Air Receiver Tanks the perfect addition to any unloading site's air system.

HORIZONTAL TANKS

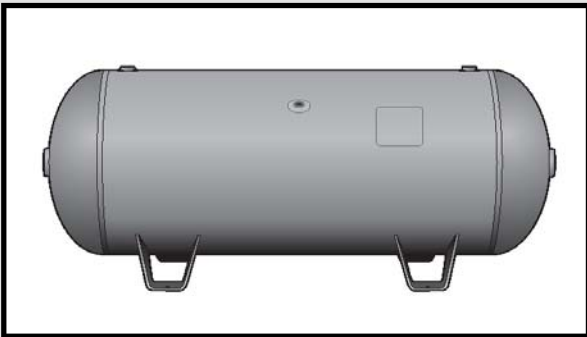

SIZE (Gal)	PART #	DIMENSION L x W x H
30	31-32030	38" x 16" x 18"
60	31-32060	48" x 20" x 22"
80	31-32080	63" x 20" x 22"
120	31-32120	68" x 24" x 26"
240	31-32240	84" x 30" x 33"

VERTICAL TANKS

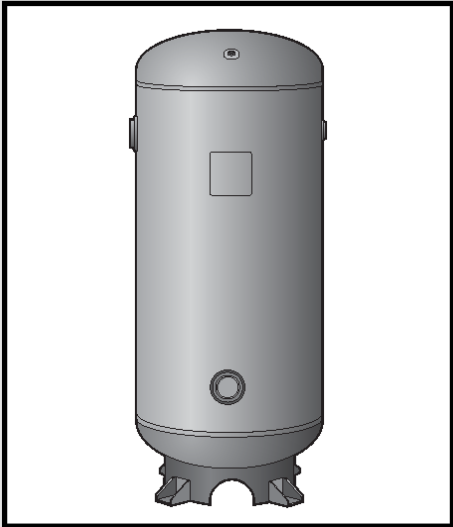

SIZE (Gal)	PART #	DIMENSION OD x H
30	31-33030	16" x 41"
60	31-33060	20" x 51"
80	31-33080	24" x 51"
120	31-33120	30" x 48"

SAFETY CUFF GLOVES

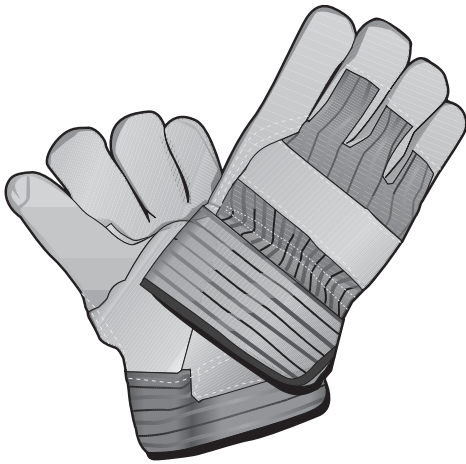

Scratched, cut, bruised or chapped hands make operating railcar opening and unloading equipment difficult and painful. Protect your hands with the world's most popular glove. These standard grade leather palm gloves provide excellent protection from your finger tips to your wrist while the fabric back breaths for comfort. (Sold per pair)

PART #

750111

KNIT WRIST GLOVES



For lighter industrial applications, this leather palm glove offers economical hand protection. Each pair is made with a fabric back for comfort, and a knit wrist to keep rail yard debris out of the glove. Durable and dexterous, these gloves are sure to be a favorite. (Sold per pair)

PART #

750011

SAFETY GLASSES



PART #	
Blue Frame	150840

Workers love UVEX's ASTROSPEC® 3000's great looks, lightweight design and snug fit. 4-way adjustable temple lengths and 3-way adjustable lenses assure a comfortable fit for all wearers. Our Blue frame has the patented comfort cushions to help relieve pressure behind the ears and prevent slippage. The clear lens gives the ultimate in visibility and meets ANSI Z87-1 Standard.

EAR PROTECTION

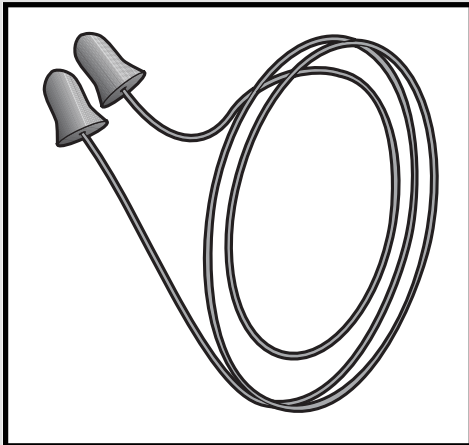

PART #
250199

Howard Leight's MAX corded earplugs are considered the most comfortable earplugs on the market. These pre-shaped foam earplugs feature the highest NRR rating available. Plus, their smooth, soil resistant skin stands up to humidity and varying weather conditions to provide superior user comfort, and keep foreign material from getting under the surface while rolling prior to insertion. The foam material rolls extremely small and expands for a custom fit and excellent attenuation. Tapered for easy insertion and removal from ear canal, the highly visible coral color make compliance checks quick and easy. MAX earplugs are non-irritating and non-allergenic for sensitive wearers. NRR 33. Meets ANSI S3.19-1974 standard. (100 per box)

THE LEGEND OF THE RAILS

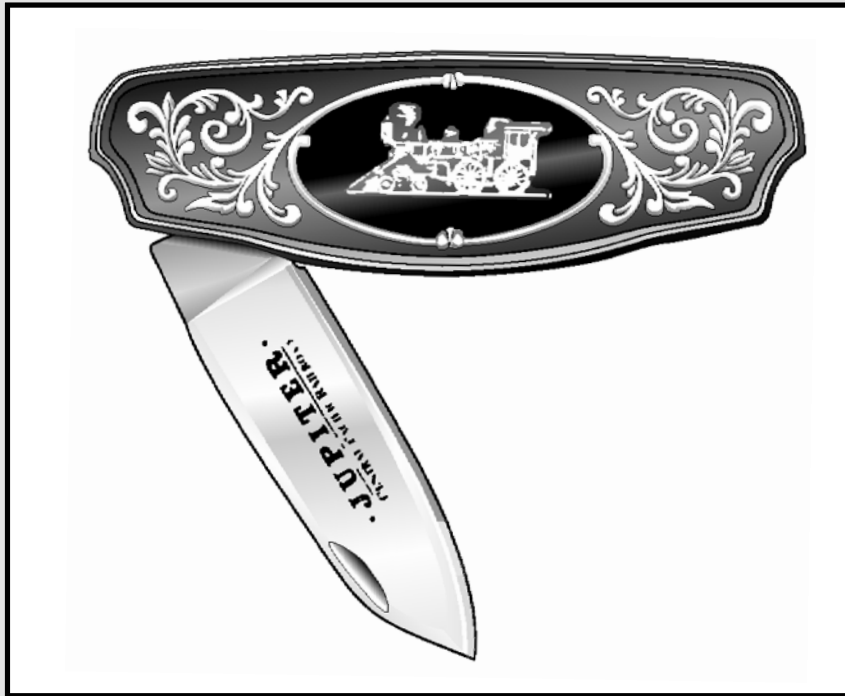

The Legend of the Rails Collector's Knife

This beautiful custom designed folding knife features a detailed pewter sculpture of "the Jupiter" locomotive accented with 24 karat gold and inset into the richly engraved and hand-finished handle. In addition, this knife features the Official Minted Medal of the Franklin Mint's Collector Knives Series. It is the first-ever pocket knife authorized and authenticated by the National Railroad Museum.

PART #

93-10005

The Legend of the Rails Collector's Knife

Check out these other WORKMASTER Product Lines:



Motor Starters & Controls

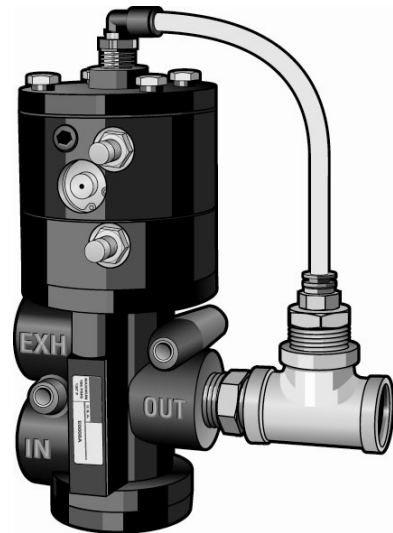

Pneumatic Timer



VIBRA-TAK Tachometer

WORKMASTER[®]

WE FIND A WAY — OR MAKE ONE !

www.workmaster.net