

RAIL-RAMMER IV

DIRECT IMPACTING LINEAR RAILCAR VIBRATOR

This Heavy-Duty Railcar Unloading Vibrator delivers a powerful, direct impact force output of 3400 lbs at 80 psi while only weighing 48 lbs. It is the highest-force, lowest-weight portable linear railcar vibrator available. The WORKMASTER® Rail Rammer IV provides the force required to prompt and maintain the free flow of even the toughest materials - sticky, coarse, and high in moisture.



PN: 12-88889

HEAVY-DUTY
LIGHTWEIGHT
POWERFUL
DIRECT IMPACTING

BENEFITS

IMPROVE UNLOADING EFFICIENCY

Linear vibrator provides powerful force to boost material flow.

SAVE ENERGY

Air-efficient design operates on air supply from 45-95 psi (3.1-6.5 bar); consumes only 25 cfm at 80 psi (5.5 bar).

SMALL BUT POWERFUL

Compact vibrator and mount assembly design provides the power to unload even the most stubborn materials.

EASY TO HANDLE

Lightweight vibrator and shoe assembly makes mounting/dismounting a "no strain" procedure.

INDUSTRY-LEADING FORCE/WEIGHT RATIO

Produces 20% to 50% more force than other similar vibrators.

REDUCE INJURIES

Vibrator and wedge system weighs only 48 lbs (21 kg), reducing risk of injury from manhandling large, unwieldy vibrators into railcar brackets.

GUARANTEED PERFORMANCE

The RAIL RAMMER IV Vibrator is covered by a 3-year warranty against defects, workmanship, and materials.



RAIL-RAMMER IV

DIRECT IMPACTING LINEAR RAILCAR VIBRATOR SPECIFICATIONS

PN: 12-88889

RAIL-RAMMER VS. THE COMPETITION

MODEL	VPM*	FORCE LBS*	NOISE dBA*	WEIGHT lbs
MARTIN PR-3	2200	985	106	73
HOUSTON QMC - 3RR	3300	1558	116	52
HOUSTON HCV - 350 - LONG	2400	2863	123	75
WORKMASTER® RAIL-RAMMER IV	3000	3400	120	48

* All data based on 80 PSI

All units require FRL Kit (Air Line Filter/Regulator w/guage/Lubricator) for proper operation

Suggested operating temperature 30°F (-1°C) and above

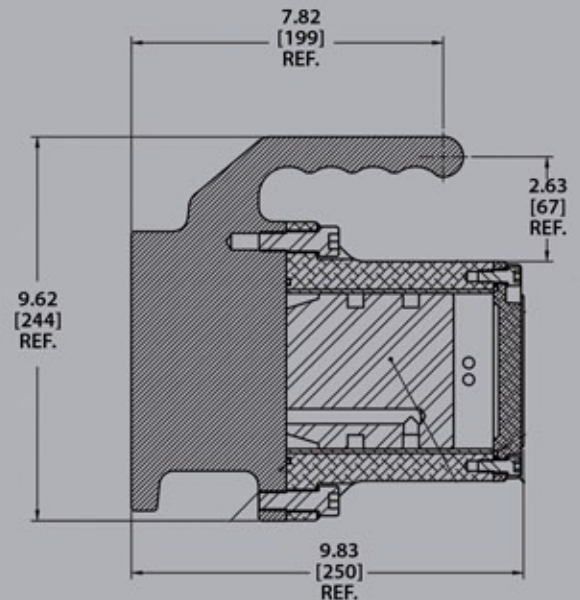
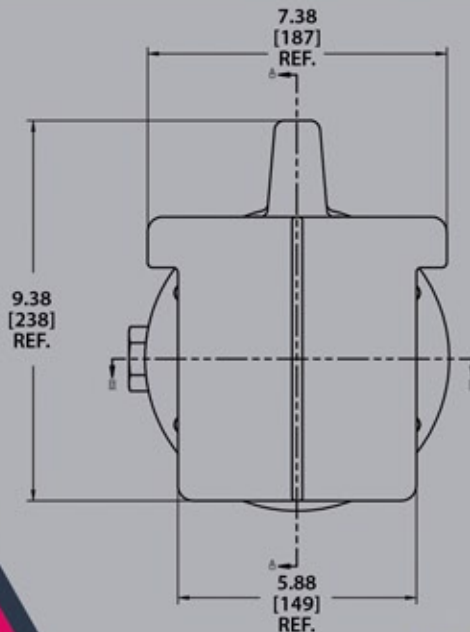

Distributed By:

AIRMATIC®
INC
...HELPING PRODUCERS EXCEL!®

284 Three Tun Rd

Malvern, PA 19355-3981

PH: 800.332.9770 FX: 888.964.3866

The **WORKMASTER**® line of unloading products, from our wide selection of gate openers and pneumatic pocket vibrators to our car pocket to undertrack conveyor connectors, offers industry leading solutions to the vexing problems of unloading hopper cars.

WORKMASTER®

WE FIND A WAY — OR MAKE ONE!

PH: 866.476.9217 FX: 866.476.9219

www.workmaster.net

FORM: WMRRIV022011