

WORKMASTER[®]

WE FIND A WAY — OR MAKE ONE!



TO-A02

Bulk Trailer Trap Opener

Address: 284 Three Tun Rd.
Malvern PA, 19355
Phone: 267.350.2809
Email: info@workmaster.net

TO-A02

Bulk Trailer Trap Opener

The **TO-A02 Bulk Trailer Trap Opener** is a hand-held pneumatic wrench with precise torque control that is optimized down to the finest detail for maximum productivity and longevity at any unloading site. The backbone of any wrench is its gears, and the gears that are the driving force behind the **TO-A02** are designed with an extreme durability factor.

The **TO-A02 Opener** has endured more from long term testing than it will ever experience at a trailer unloading site. Based on air pressure adjustment, the **TO-A02 Opener** produces **78-lbf to 530-lbf**; when the air regulator is at **20-PSI**, the Opener produces **145-lbf at 20-RPM**; when set at **40-PSI**, the Opener produces **250-lbf at 25-RPM**. An airflow of **50 to 55 CFM** guarantees optimum performance at **20 to 40-PSI**.



PERFORMANCE DATA	
RPM @ 10 psi	16.5
RPM @ MAX psi	44
TOOL MAX psi	80
MIN. TORQUE (ft/lbs)	78
MAX. TORQUE (ft/lbs)	530
dB (a)	≤ 85
Weight lbs. (as shown)	16.75
WRENCH DIMENSIONS	
SQUARE DRIVE A	.75"
LENGTH B	2.56"
LENGHT C	6.8"
LENGHT D	7.89"

Features

- 1 Hardened alloy steel for durability and long cycle life
- 2 Bearings support the loads experienced at the square drive
- 3 Multi-stage planetary gear systems with optimized tooth design
- 4 Smooth ball bearing rotation of the gearbox housing independent from the motor handle
- 5 Lightweight aluminum handle with durable, slip-resistant textured coating
- 6 Ultra-efficient air motor designed for easy maintenance
- 7 Cartridge-style valves provide easy replacement
- 8 One finger trigger control for forward and reverse
- 9 O-rings seal grease in while keeping water and dirt out
- 10 Thrust bearing between stages isolate the motor when used in all orientations
- 11 Gears run on low friction, high strength bearing sleeves
- 12 Tool steel pins in each stage carrier

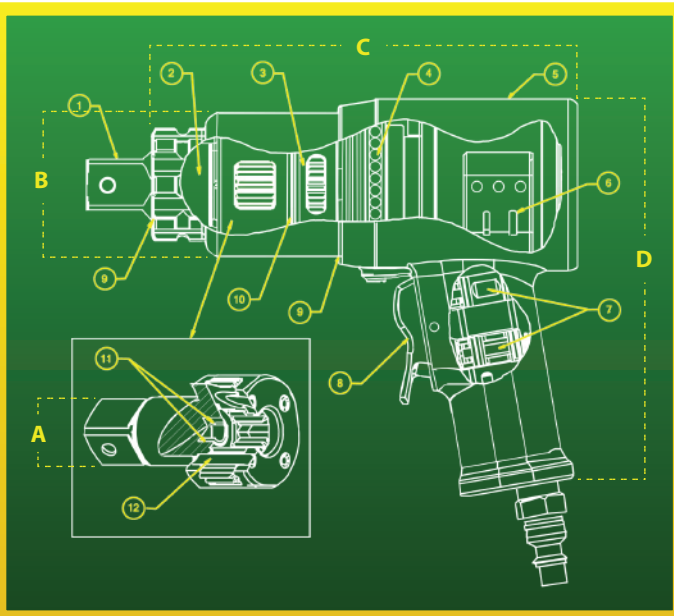

TO-A02

Bulk Trailer Trap Opener

WORKMASTER
WE FIND A WAY — OR MAKE ONE!

A DRIVE FITTING FOR EVERY TRAILER

Trailer Trap Capstans fall into three general categories: (1) the standard 1-1/2" socket style capstan; (2) the 1" slotted-pin style capstan; (3) the 1" square bit style capstan found on CORNHUSKER style trailers. The **TO-A02** comes complete with a Capstan Drive Fitting for each of these three trailer capstan styles.

STANDARD TRAP



**1-1/2" SOCKET
STANDARD DRIVE FITTING**
(16.75 LBS FULLY ASSEMBLED)

PIN STYLE TRAP

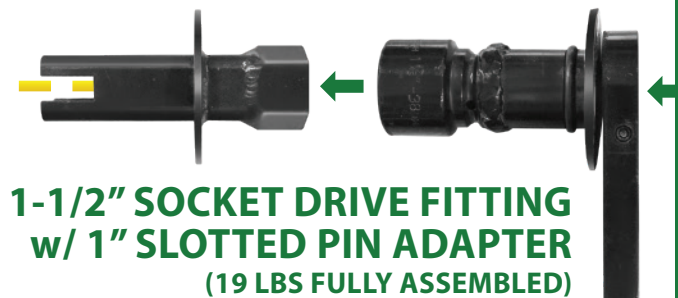

**1-1/2" SOCKET DRIVE FITTING
w/ 1" SLOTTED PIN ADAPTER**
(19 LBS FULLY ASSEMBLED)

CORNHUSKER STYLE TRAP



**1-1/2" SOCKET
DRIVE FITTING
w/ 1" SQ DR ADAPTER**
(20 LBS FULLY ASSEMBLED)

WRENCH (9 LBS)



Multi-Position Side Handle

Removable multi-position side handle comes standard with seven different mounting positions for increased operator comfort during use.

Forward/Reverse Two Position Trigger

After securely engaging the drive fitting in the trailer's capstan, a simple press of the trigger on the pistol grip handle will cause the torque reaction arm to rotate until it is stabilized against the trap, and the drive fitting begins to open/close the hopper; then, within seconds the **TO-A02** will stall at the preset torque. To reverse the direction of rotation, simply depress the trigger in the opposite direction to release the stored torque load off the reaction arm.

Air Supply Kit

Every **TO-A02** comes complete with: 10-ft of Air Hose, fitted with a 1/2" NPT x QC Coupler; A Compressed Air Filter, Regulator, Lubricator Assembly in a HD Carrier for ease of use and protection; Air Tool Oil(1-Qt).



TO-A02

Bulk Trailer Trap Opener

WORKMASTER®

WE FIND A WAY — OR MAKE ONE!

TO-A02 KIT COMPONENTS



ITEM	P/N	DESCRIPTION
1	32-70800	Torque Wrench
2	32-70802	Multi-Position Side Handle
3	36-21010	Air Tool Oil
4	33-10050	Drive Socket Adapter f/Wilson Type Trailers
5	33-10045	Standard Drive Socket
6	32-70805	Torque Reaction Arm
7	33-10056	Drive Fitting w/ Extended Reaction Arm f/ Cornhusker Type Trailers
8	32-90022	Utility Bag
9	32-70801	Air Supply Kit
10	32-70807	Hose Assembly 10 ft, f/ TO-A02
11	32-50122	Retaining Pin
12	32-50005	Retaining Ring
13	33-B3005	Shoulder Bolt
14	33-B3006	Allen Wrench

STANDARD SETUP

DIMENSIONS

LENGTH A	5.75"
DRIVE FITTING B	1.5"
LENGTH C	12.75"

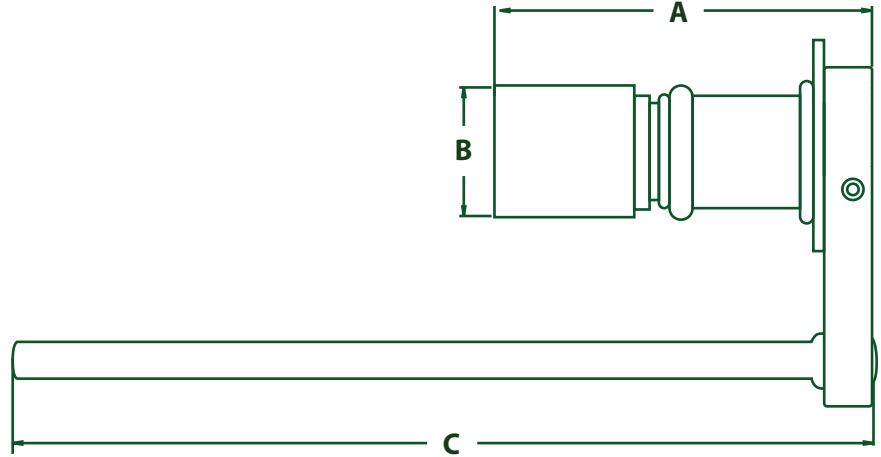

PIN STYLE SETUP

DIMENSIONS

LENGTH A	10.375"
DRIVE FITTING B	1.5"
LENGTH C	12.75"

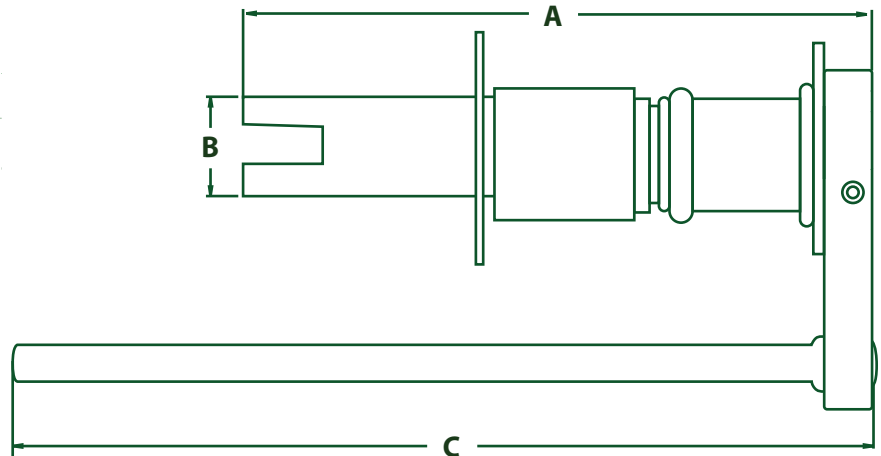

CORNHUSKER STYLE SETUP

DIMENSIONS

LENGTH A	9.25"
DRIVE FITTING B	1"
LENGTH C	16.75"

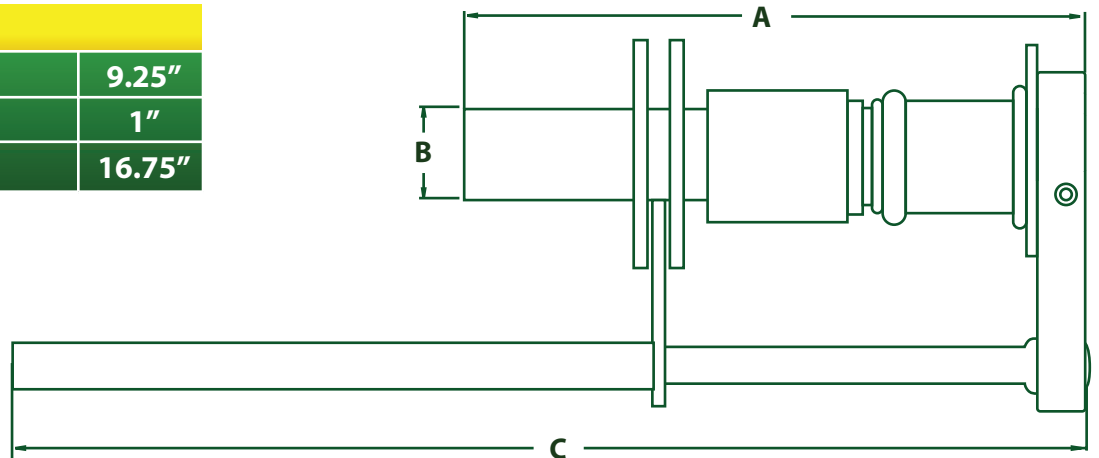

BULK TRAILER TRAP OPENERS

WORKMASTER
WE FIND A WAY — OR MAKE ONE!

TO-E02-MP

The Electric over Hydraulic powered WORKMASTER **TO-E02-MP** Mobile Position Bulk Trailer Trap Opener features an onboard motor mounted to a 4 wheeled base for unloading sites that require complete maneuverability along the unloading zone.



TO-E02-NA

The Electric over Hydraulic powered WORKMASTER **TO-E02-NA** Narrow Aisle Bulk Trailer Trap Opener is powered by a remote mount motor unit, and is designed for sites that are especially confined in space yet still require maneuverability along the unloading zone.



TO-E02-TK

The Electric over Hydraulic powered WORKMASTER **TO-E02-TK** Track Mounted Bulk Trailer Trap Opener is wall mounted at your unloading site with a remote mount motor unit. This model is able to be positioned on or against a wall at your unloading site. The standard unit allows the **TO** to be slid up to 20' along the track (multiple tracks extend range).

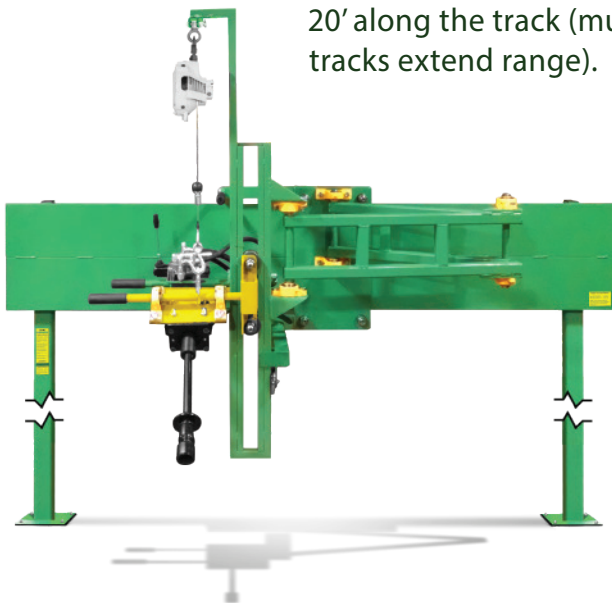

TO-E02-FP

The Electric over Hydraulic powered WORKMASTER **TO-E02-FP** Fixed Position Bulk Trailer Trap Opener is ground mounted at your unloading site with a remote mount motor unit. This model is best suited for sites with an unloading zone that's limited to 10 ft.



WORKMASTER®

WE FIND A WAY — OR MAKE ONE!

WORKMASTER® is a manufacturer of labor savings bulk material handling tools to help safely and efficiently unload, transport, store and process bulk solids from hopper bottom railcars, bulk trailers, bins, silos and chutes. To help Customers gain maximum benefit from our bulk materials handling tools and equipment, we also supply a complete line of operating, mounting, and maintenance products and accessories, such as Timers and Motor Controls, Vibrator Mounts, and Lubricating Oils to help keep your unloading site tools running longer and more efficiently. WORKMASTER products help Customers work more safely and efficiently, increase the lifespan of production-critical equipment, and decrease operating and maintenance costs of tools and equipment used in some of Industry's most dangerous, difficult, and dirty jobs.



Address: 284 Three Tun Rd.
Malvern PA, 19355

Phone: 267.350.2809

Email: info@workmaster.net